

HCD-1

ASSESSOR'S BLOCK BOOK FOR HARRIS COUNTY, TEXAS  
UNIVERSITY PLACE RETIREMENT

JAMES WELLS SURVEY  
ABS (TRACT NO. 530

or Addition CENTER PARTIAL REPLAT Plat No. 95-193 S.D. 01 Village  
Description: 10.322 ACRES UNIVERSITY PLACE RETIREMENT CENTER/SHARPS TOWN SEC. 3A VOL. 94 PG. 97

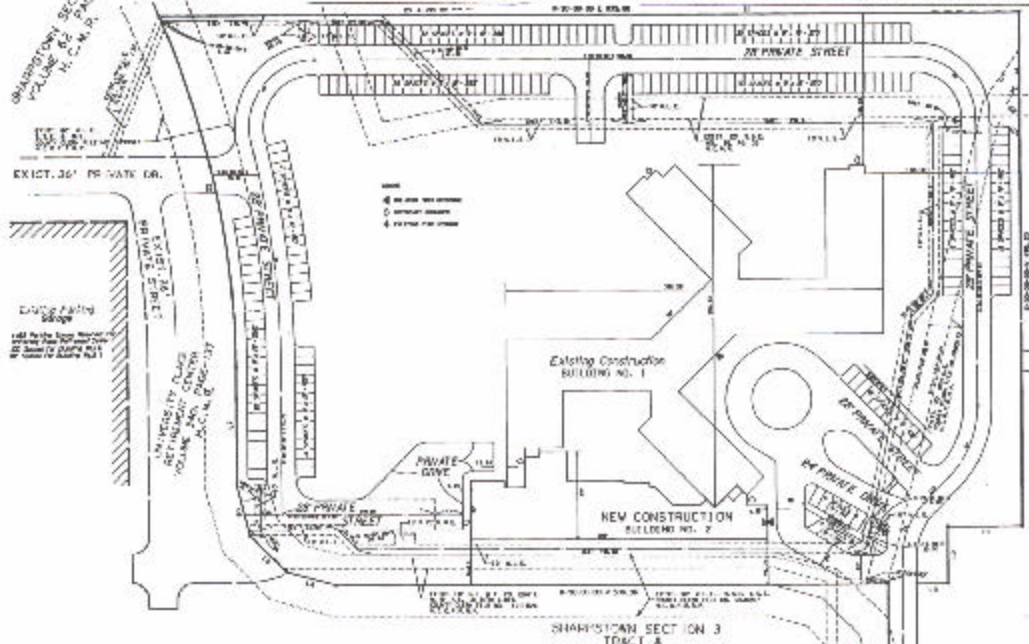

WHOM ISSUED

EXIST. 20' PR. WALK DR.  
EXIST. 20' PR. WALK DR.  
EXIST. 20' PR. WALK DR.

SHARPS TOWN SECTION 3 TRACT A

UNIVERSITY PLACE  
RETIREMENT CENTER  
VOLUME 94, PAGE 173  
H.C.M.R.

JAMES WELLS SURVEY A-830  
VICINITY W. WELLS SURVEY A-1257



Scale 100' = one inch.  
OWNERS:  
MEMORIAL HOSPITAL SYSTEMS  
MEMORIAL SENIOR SERVICES INC.  
HOUSTON BAPTIST UNIVERSITY

REF. AT A EXTENSION OF  
SHARPS TOWN SECTION 3-A  
VOLUME 95 PAGE 33  
H.C.M.R.



VICINITY MAP

RESEARCH STREET  
120' R.O.W.

S.E. CORNER OF THE  
JAMES WELLS SURVEY  
ABSTRACT 530

JAMES WELLS SURVEY A-830