

HCD-1

ASSESSOR'S BLOCK BOOK FOR HARRIS COUNTY, TEXAS

J.H. WALTON SURVY'S  
 Abstract No. A-052 Survey or Addition M & L RESERVE "A" Plat No. 95-61 S D 01 Village  
 Description: A PARTIAL REPLAT OF 92604 ACRES (33 OF DIPLMNT COURT REPLAT) 1926 50 1/2

PATENT					CERTIFICATE					
No.	Vol.	TO WHOM ISSUED	DATE			ACREAGE	No.	CLASS	CHARACTER	TO WHOM ISSUED
			M	D	Y					

Scale 1/20" = one inch.  
 DOUBLE  
 7501 Harris, LTD.

REASON FOR REPLAT  
 TO SUBDIVIDE PART OF EPT. DPT.  
 COURT INTO A COMMERCIAL PLAT

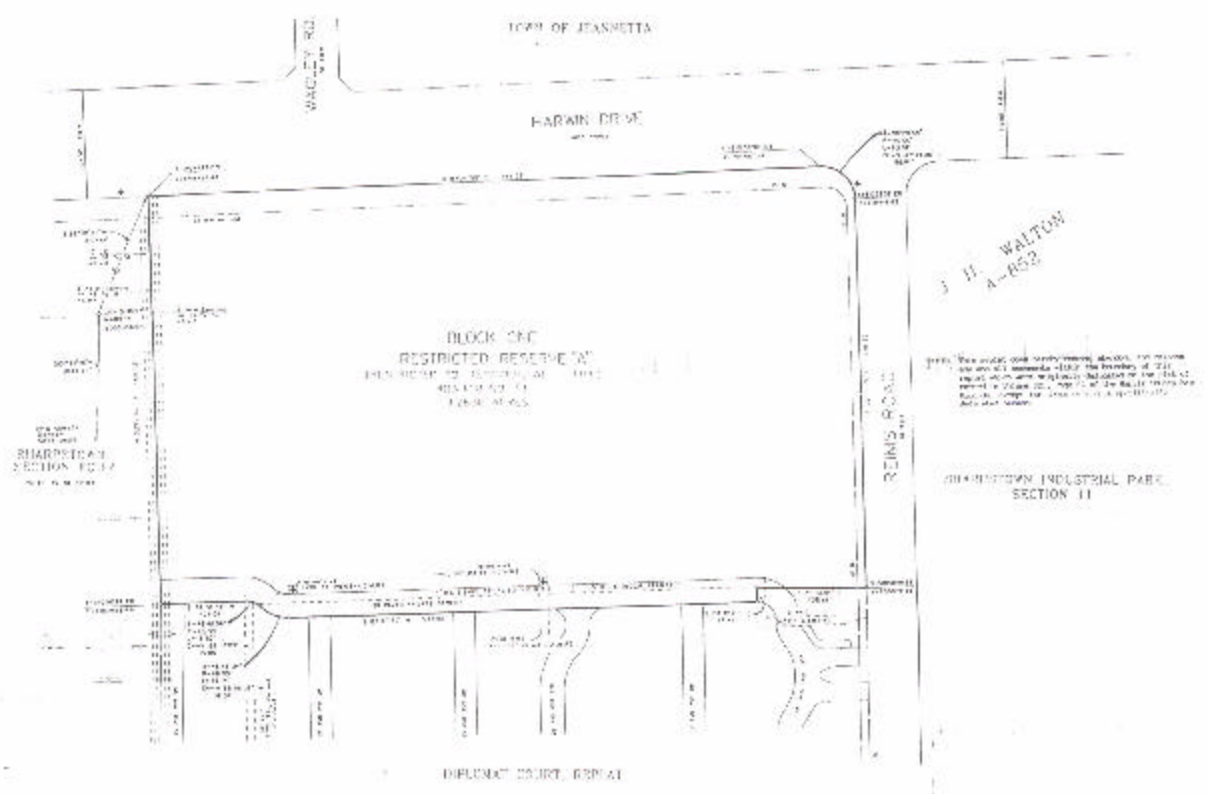

2