

ASSESSOR'S BLOCK BOOK FOR HARRIS COUNTY, TEXAS  
**THE COURT AT MUSEUM'S GATE AMENDED**

O. SMITH SURVEY  
 ABSTRACT NO. 696

Survey or Addition: \_\_\_\_\_ Plat No. 95 S.D. 01 Village \_\_\_\_\_  
 Description: (1.1478 ACRES) MONTROSE ADDN. LOTS 1 THRU 7, 15, & 16 BLK. 39 (VOL. 26 PG. 165)

PATENT					CERTIFICATE				
No.	Vol.	TO WHOM ISSUED	DATE			No.	CLASS	CHARACTER	TO WHOM ISSUED
			W	D	Y				

SCALE: NTS - ONE INCH  
 OWNER:  
 LA PORTE II L.L.C.

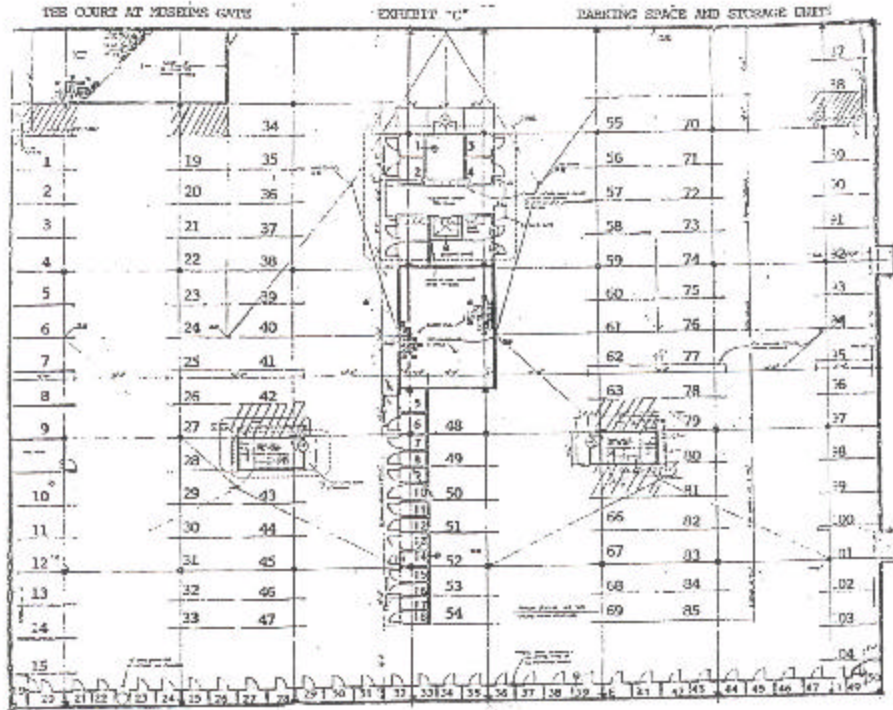

UNIT NO.	UNIT TYPE	TOTAL AREA	PERCENTAGE OF SHAREABLE
1	O	1,688	1.744
2	O	1,688	1.744
3	P-1	1,831	3.012
4	P-1	1,831	3.012
5	P-2	1,873	3.193
6	P-2	1,873	3.193
7	O	1,872	2.706
8	O	1,872	2.706
9	M-1	1,434	2.321
10	M-1	1,434	2.321
11	M-5	1,410	2.282
12	M-5	1,410	2.282
13	M-2	1,362	2.253
14	M-2	1,362	2.253
15	D	1,220	1.974
16	D	1,220	1.974
17	F	1,276	2.068
18	F	1,276	2.068
19	N	1,662	2.818
20	N	1,662	2.818
21	E	689	1.460
22	E	689	1.460
23	E	651	1.377
24	M	1,339	2.157
25	M	1,339	2.157
26	A	725	1.173
27	L	5,905	3.008
28	L	5,905	3.008
29	J	1,271	2.057
30	J	1,271	2.057
31	C	1,425	2.308
32	C	1,425	2.308
33	C	973	1.570
34	C	973	1.570
35	K	1,271	2.057
36	K	1,271	2.057
37	A	1,484	2.370
38	A	1,484	2.370
39	H	851	1.377
40	H	851	1.377
41	E	1,339	2.157
42	E	1,339	2.157
43	L	725	1.173
44	L	1,508	3.058
45	K	1,464	2.379
46	K	1,464	2.379
47	F	1,309	2.107
48	F	1,309	2.107
49	E	811	1.407
50	B	948	1.646
51	E	525	1.000
52	E	811	1.407
53	E	811	1.407
54	E	811	1.407
55	E	811	1.407
56	E	811	1.407
57	E	811	1.407
58	E	811	1.407
59	E	811	1.407
60	E	811	1.407
61	E	811	1.407
62	E	811	1.407
63	E	811	1.407
64	E	811	1.407
65	E	811	1.407
66	E	811	1.407
67	E	811	1.407
68	E	811	1.407
69	E	811	1.407
70	E	811	1.407
71	E	811	1.407
72	E	811	1.407
73	E	811	1.407
74	E	811	1.407
75	E	811	1.407
76	E	811	1.407
77	E	811	1.407
78	E	811	1.407
79	E	811	1.407
80	E	811	1.407
81	E	811	1.407
82	E	811	1.407
83	E	811	1.407
84	E	811	1.407
85	E	811	1.407
86	E	811	1.407
87	E	811	1.407
88	E	811	1.407
89	E	811	1.407
90	E	811	1.407
91	E	811	1.407
92	E	811	1.407
93	E	811	1.407
94	E	811	1.407
95	E	811	1.407
96	E	811	1.407
97	E	811	1.407
98	E	811	1.407
99	E	811	1.407
100	E	811	1.407