

ASSESSOR'S BLOCK BOOK FOR HARRIS COUNTY, TEXAS

Block or  
Abstract No. **844** Series or Addition **WESTCHASE GARDENS CONDO PH.2** Plat No. **84-455** S11 **08** Village  
 Date of Plat. **4.12.20** Acs. **HENRY WOODRUFF SUR. RESUBD. PT. RES. B BLK. 2 WESTCHASE SEC. 13 VOL. 114 P. 9.146-2**

PATENT				CERTIFICATE			
No.	Vol.	TO WHOM ISSUED	DATE	ACREAGE	No.	CLASS	CHARACTER
			M	D			
			Y	TO WHICH ISSUED			

Scale = one inch

WESTCHASE SUBDIVISION SECTION TWELVE VOL. 765 PG 74 H.C.M.R.  
 UNRESTRICTED RESERVE "E" BLOCK 1

RICHMOND 100' RDW AVENUE

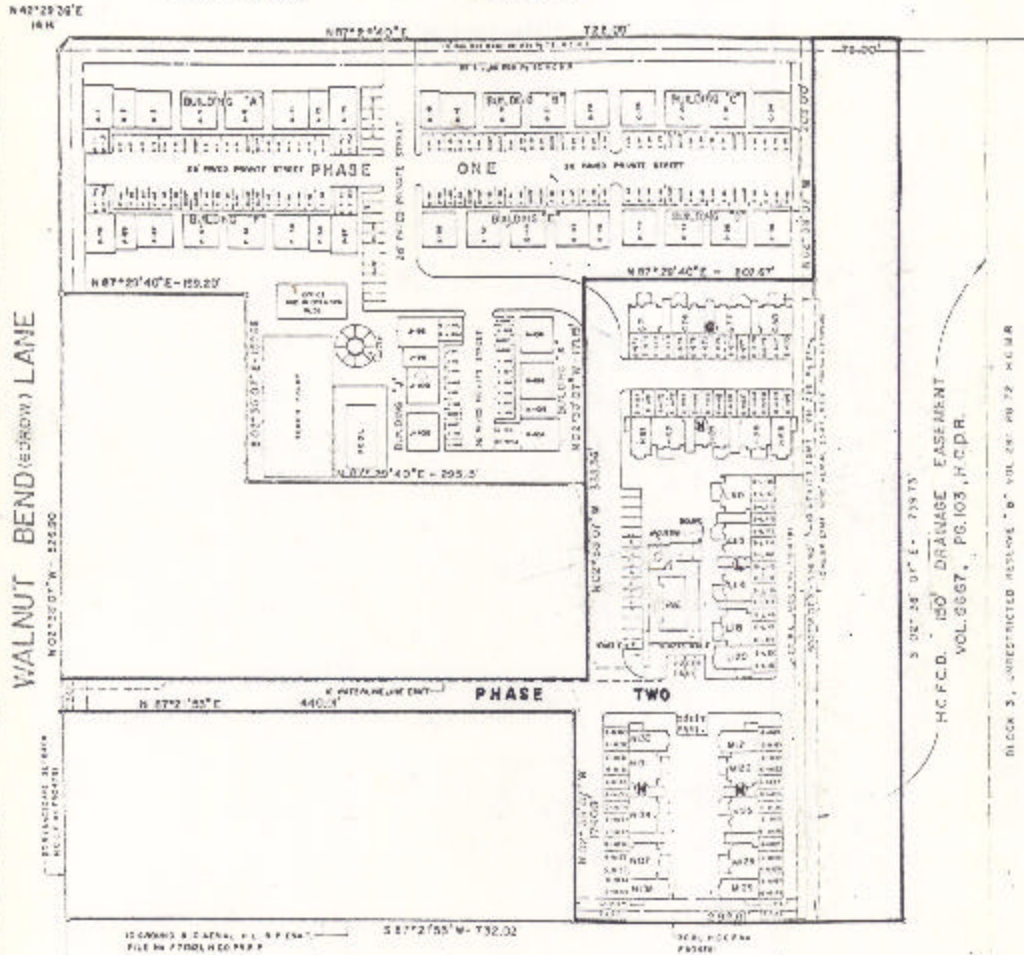

WALNUT BEND APARTMENTS  
 VOL. 272 PG. 54

WALNUT BEND (RDW) LANE  
 N 02° 15' 01" W - 525.90'

H.C.P.C.D. 100' DRAINAGE EASEMENT  
 VOL. 8667, PG. 103, H.C.P.R.

BLOCK 2, UNRESTRICTED RESERVE "E" VOL. 287 PG 72 H.C.M.R.