

ASSESSOR'S BLOCK BOOK FOR HARRIS COUNTY, TEXAS

Block or Abstract No. 248 Survey or Addition WESTCHASE GARDENS QUID Plat No. 82-207 S. D. 08 Village
 Description: ALBERTA HENRY WOODRUFF SUR.

PATENT					CERTIFICATE				
No.	Vol.	TO WHOM ISSUED	DATE			No.	CLASS	CHARACTER	TO WHOM ISSUED
			M	D	Y				

Scale *N.T.S.* = one inch. PAGE 3 of 3

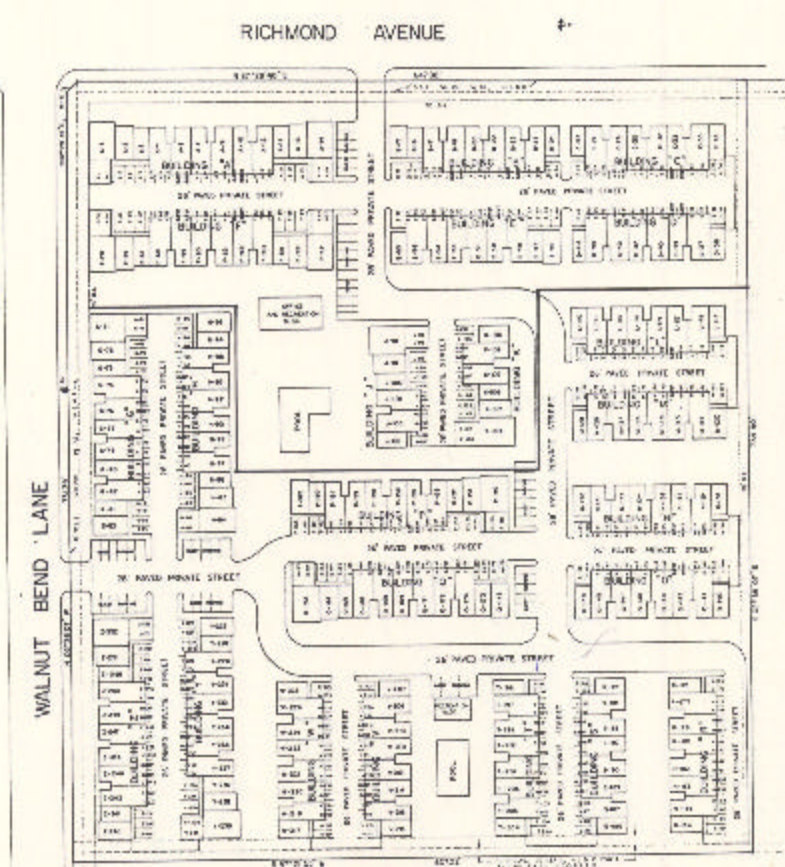

SECOND FLOOR LAYOUT