

ASSESSOR'S BLOCK BOOK FOR HARRIS COUNTY, TEXAS

Block or Abstract No. 696 Survey or Addition. 811 LOVETT BLVD. TOWNHOUSE Plat No. 72-192 S. D. M. Village

Description: CONDOMINIUM

PATENT				CERTIFICATE				
No.	Vol.	TO WHOM ISSUED	DATE	ACREAGE	No.	PLANS	CHARACTER	TO WHOM ISSUED

Scale 10' = one inch.

PLATE: 10 OF 12.

FIRST STORY

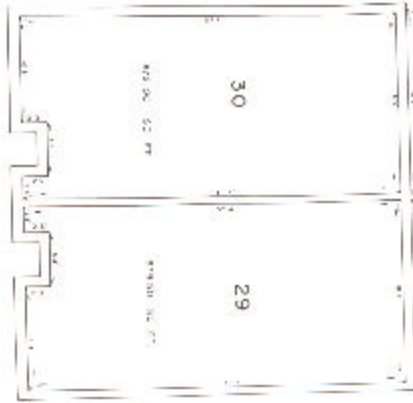

BUILDING

F

SECOND STORY

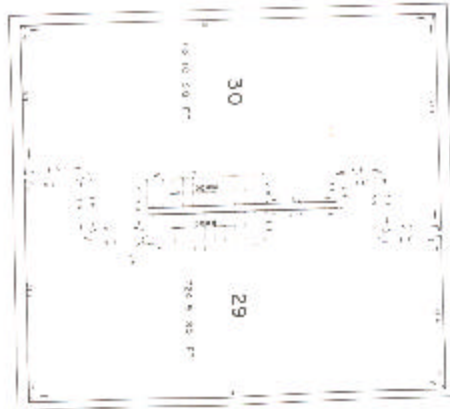

BUILDING

F

