

ASSESSOR'S BLOCK BOOK FOR HARRIS COUNTY, TEXAS

Block or Abstract No. *1 to 15* Survey or Addition *APTON 2445* Plat No. *S. D. Society D. D.*

PATENT				CERTIFICATE				
No.	Vol.	TO WHOM ISSUED	DATE	ACREAGE	No.	CLASS	CHARACTER	TO WHOM ISSUED

Scale 200 = one inch.  
 JOHN 1865 DEEDS 2726 1/2 AC.  
 1865 WARD AND ORIGINAL 2000 1/2  
 FRANK LARSON ET AL 1870 1/2 AC.  
 CHAS. H. WARD ET AL 1877 1/2 AC.  
 H. E. STULLMAN ET AL 1880

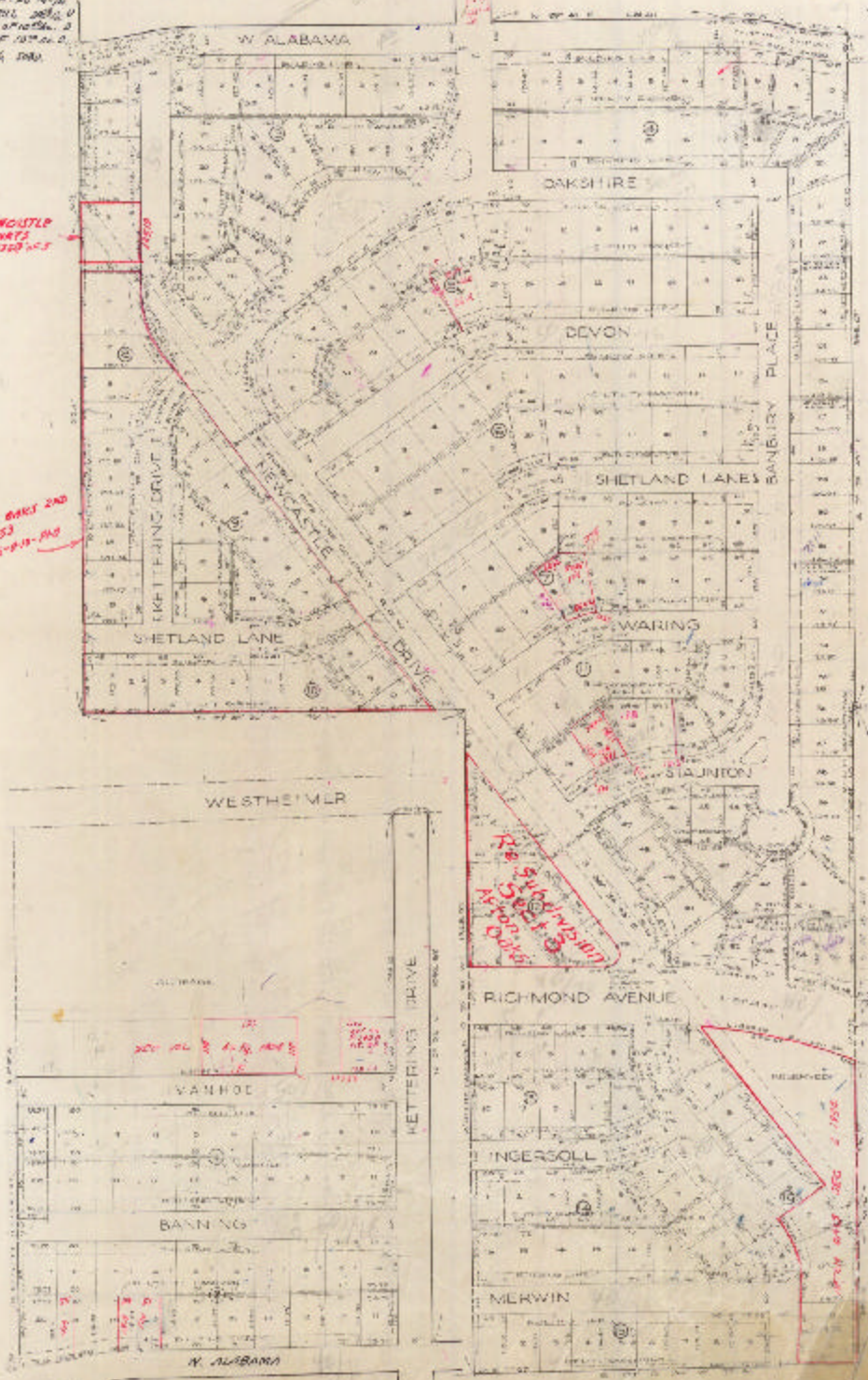

*Sales 1951  
 50¢ sq ft  
 assessed  
 10¢ 1947  
 22¢ 1952  
 Smith*

*20' unit for  
 1952*