

ASSESSOR'S BLOCK BOOK FOR HARRIS COUNTY, TEXAS

Block or Abstract No. 10 Survey or Addition RICE COURT Plat No. S. D. 100 T. D. 12

No.	Vol.	PATENT			ACRAGE	No.	CERTIFICATE		TO WHOM ISSUED
		TO WHOM ISSUED	DATE	CLASS			CHARACTER		
			M	D	Y				

Scale 100 - one inch.

124-114 31007

Revalued 19 67
Unit 30 F.F.

Monmouth 16

*530 12-1907
RICE BLVD.*

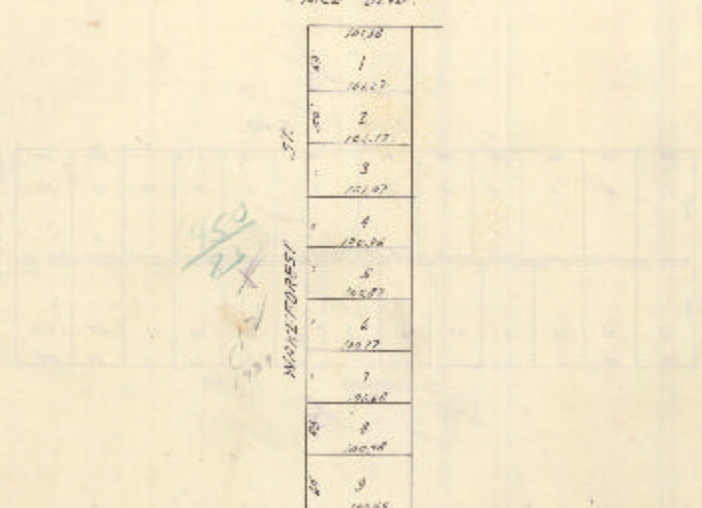

10138
1
16.67
2
16.67
3
16.67
4
16.67
5
16.67
6
16.67
7
16.67
8
16.67
9
16.67

*ANNEX ST.
530 12-1907*

When an owner or other party, with regard to the respective years specified, makes application for such years as to the respective years, and items listed by said subdivisions were given

into tracts Nos. _____	Tract No. _____	subdivided in 10 _____	into tracts Nos. _____
into tracts Nos. _____	Tract No. _____	subdivided in 10 _____	into tracts Nos. _____
into tracts Nos. _____	Tract No. _____	subdivided in 10 _____	into tracts Nos. _____
into tracts Nos. _____	Tract No. _____	subdivided in 10 _____	into tracts Nos. _____