

ASSESSOR'S BLOCK BOOK FOR HARRIS COUNTY, TEXAS

Block or Abstract No. 14 Survey or Addition SOUTHAMPTON Plat No. S. D. 4177 H. D. CITY

PATENT					CERTIFICATE				
No.	Vol.	TO WHOM ISSUED	DATE			No.	CLASS	CHARACTER	TO WHOM ISSUED
			M	D	Y				

Scale 200 —one inch.

Revalued 19 65
Unit 35⁰⁰ F.F.
50' 1977

map 36

SUNSET BOULEVARD

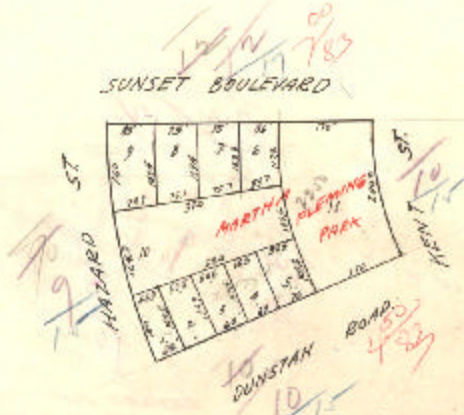

REVISED PLAT FOR 1957
SHOWS 10 + 11 AS PARK
VOL 66 P. 235.

Block as shown on state plat, were made in the respective years specified below according to the original plat, or its amended plat, and tracts formed by said subdivisions were also

18	into tracts Nos.	Tract No.	subdivided in 18	into tracts Nos.
19	into tracts Nos.	Tract No.	subdivided in 19	into tracts Nos.
20	into tracts Nos.	Tract No.	subdivided in 20	into tracts Nos.
21	into tracts Nos.	Tract No.	subdivided in 21	into tracts Nos.
22	into tracts Nos.	Tract No.	subdivided in 22	into tracts Nos.